

Using OSM for Neighborhood Development

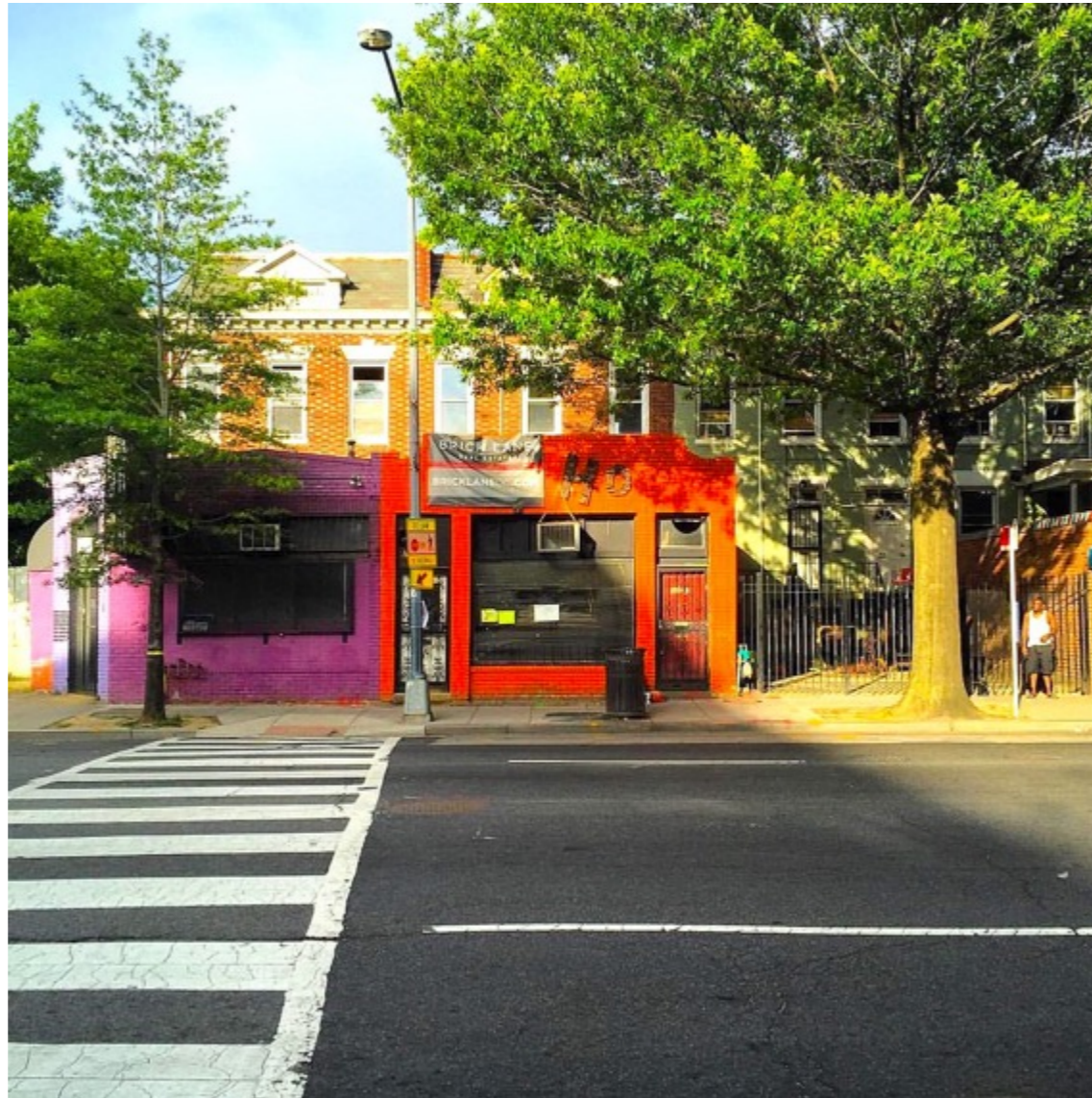

Andrew Wiseman
MaptimedC/MappingDC

(Or, don't just map)

Field surveys

Collecting data in the field (like your neighborhood)

- FieldPapers.org: printable maps for walking around

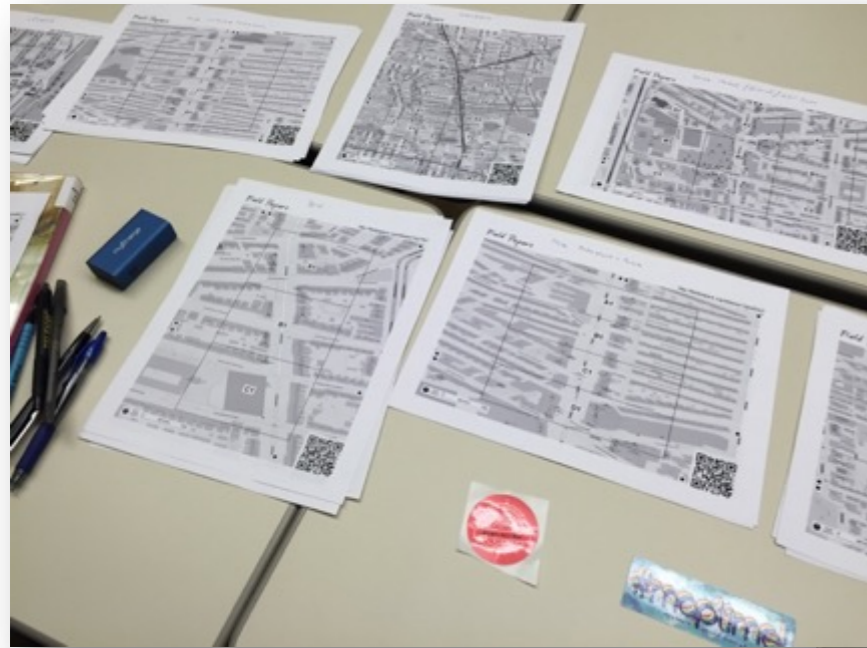

- Mapillary & OpenStreetView: DIY street imagery
- Data collection apps: Pushpin, OSMand, Go Map!!, maps.me



Field surveys are great

- They're fun!
- You notice things you wouldn't normally notice
- You'll see your area in a different way
- Great for teaching geography too



But what happens next?

Connecting OpenStreetMap with local groups = you can do a lot more good



Case Study part 1: Georgia Avenue Youth Mappers in Washington, DC



Mentors of Minorities
in Education, Inc.

VOLUNTEER

DONATE

[about us](#)

[programs](#)

[get involved](#)

[media](#)

[contact](#)





GEORGIA
3308

HAIR BEAUTY INSTITUTE
202-291-1909

Hair Beauty Institute
Certified Cosmetology
Education Provider
302-291-1909

3328

NAILS

ESPIRIOS PANAMENOS
RESTAURANT & CATERING

COLONY CLUB

3118

Colony

TH WEST
AL CARE
91-1610



3205 GEORGIA AVE

THE GIBSON

THE GIBSON







Small white sign with illegible text in the upper left corner of the window.



Small white sign with illegible text in the center of the window.



Large, stylized white word 'FEMOT' written across the middle of the window.



Small white sign in the bottom left corner with the text 'Emily Sloat Shaw' and a QR code.



JESUCRISTO ES EL SEÑOR DE WASHINGTON
JESUS CHRIST IS THE LORD OF WASHINGTON

Remote volunteers mapped buildings via a Tasking Manager project

#579 - Washington, DC Georgia Avenue Youth Mapping (Archived)

[Edit](#) [Export](#)

Description

Instructions

Contribute

Activity

Stats

⚠ This project was archived.

20 students who are part of the city's Summer Youth Program are working with the Georgia Avenue Community Development Task Force, Georgia Avenue Business Alliance and MOMIEs TLC, a local educational nonprofit, to learn about businesses, entrepreneurship and local history. Mapping DC is helping them collect and put the data it on OpenStreetMap so everybody can use it going forward. Please map the buildings, starting with those facing Georgia Avenue.

The map data will also be used for a local business directory and in a business needs assessment survey in the area.

Created by [Marion Barry](#) - Updated 8 months ago - Priority: low

[Instructions](#)

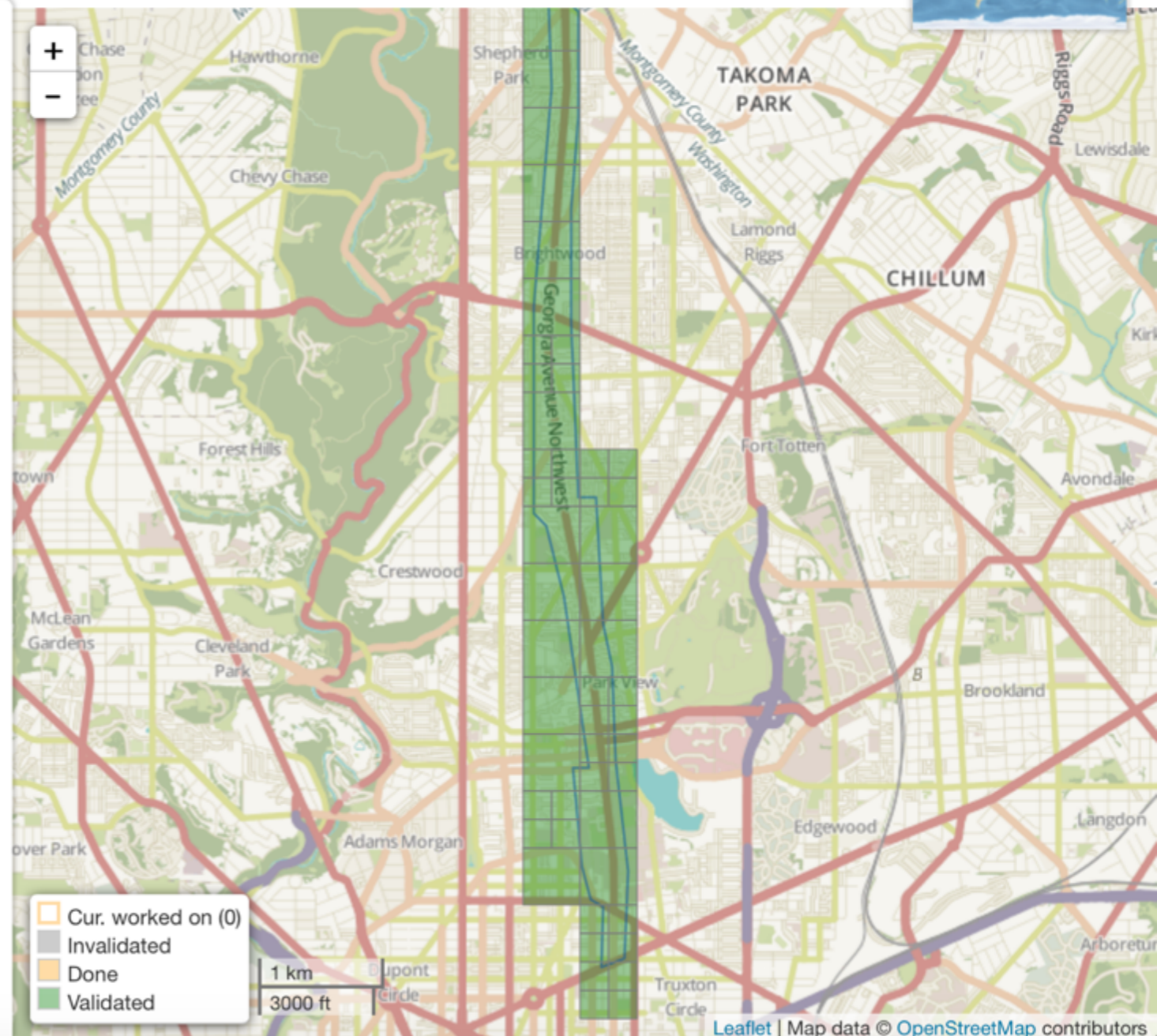

2014 Georgia Avenue Business Alliance (GABA) Questionnaire

“Georgia Avenue on my Mind Project”

Started: _____

Completed: _____

1. Address 1: _____ Suite #: _____

City: _____ State: _____ Zip/Postal Code: _____

Address 2: _____ Suite #: _____

City: _____ State: _____ Zip/Postal Code: _____

2. Company: _____

Hours: _____

3. First: _____ Last: _____

Male: _____ Female: _____ Veteran Y/N Disability Y/N

4. Job Title: B/O: _____ P/O: _____ M: _____ Other: _____

5. Office: _____ Office 2: _____

6. Home: _____ Home 2: _____

7. Mobile: _____

8. Fax: _____ Other: _____

(1)

9. E-mail: _____

E-mail 2: _____

Web Page: _____



20 new mappers

300 businesses added to the map



Lessons learned

- Work with an existing group! Don't reinvent the wheel
- Base data ahead of time
- Multiple "helper" volunteers
- Mapping is fast; organizing is slow

(More on the OSM Wiki:Georgia Avenue Youth Mapping)

So, that's great...

- Created lots of new data, taught kids about mapping
- But basically a one-off — after the program, the kids scattered to school, friends, work etc.
- **So how do you keep things going, and what else can you do with OSM data?**

You should work with existing local groups

- Neighborhood organizations, chamber of commerce, Main Street orgs and business improvement districts...
- Longer-term view of things, lots of ideas for what to do, connections, volunteers, local knowledge and more

The idea: you can use OSM to facilitate neighborhood discussion, raise questions, suggest projects

But what projects? What questions?
That's why getting connected with a neighborhood group is a good idea.



Georgia Avenue Buildings

Put your mouse over a dot for more info

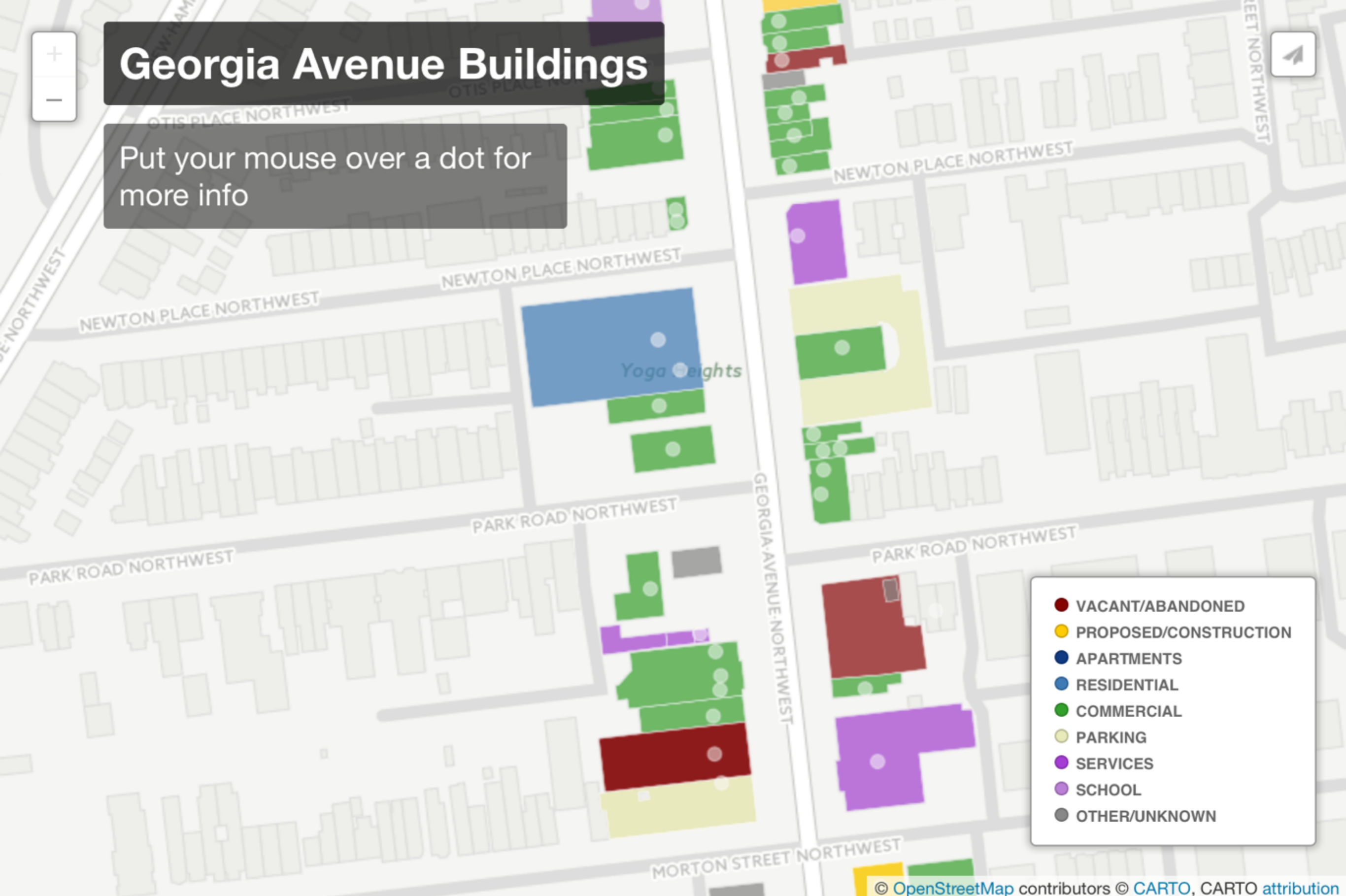

CARTO (formerly CartoDB)

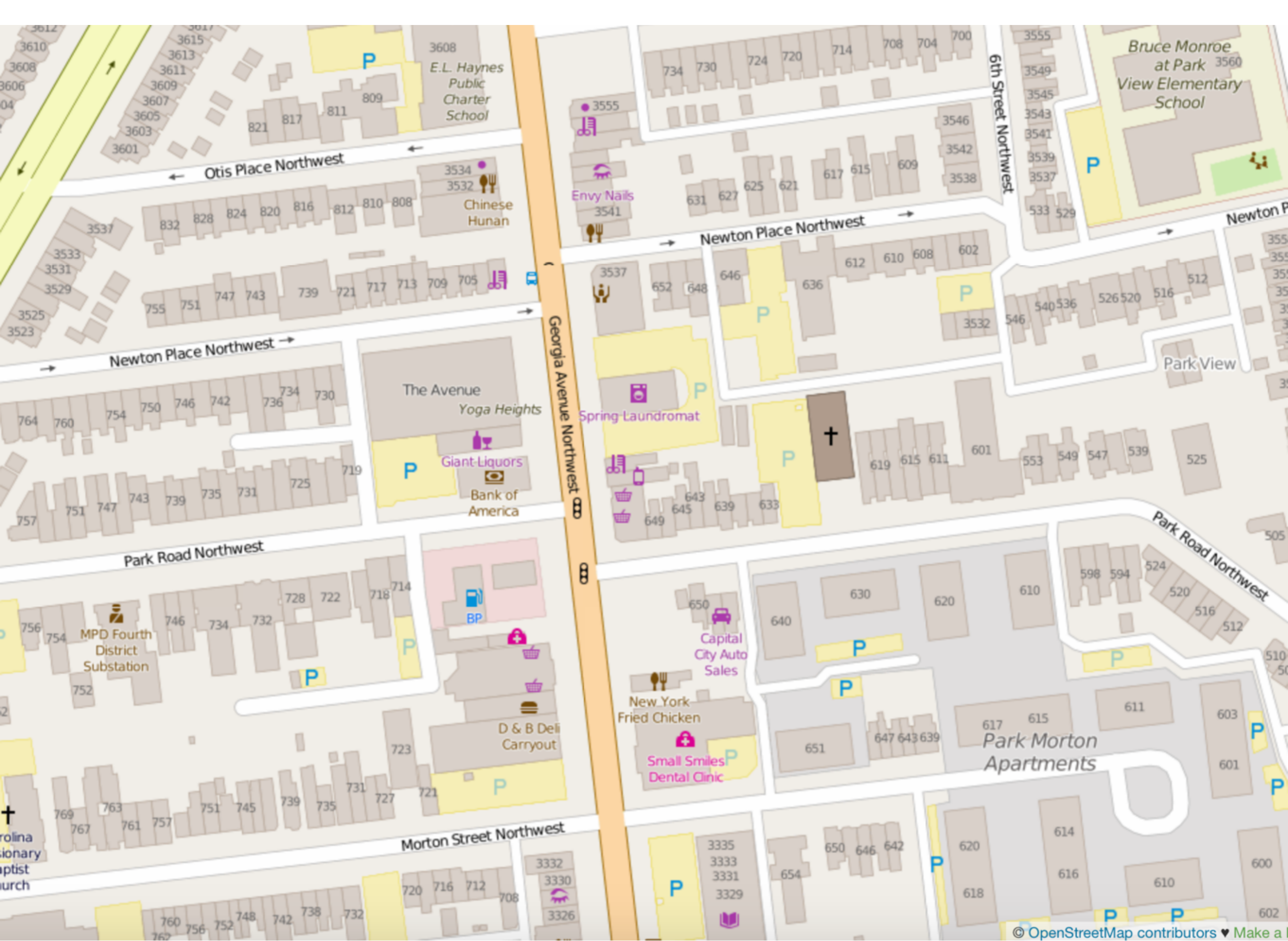

Otis Place Northwest

Newton Place Northwest

Newton Place Northwest

Park Road Northwest

Morton Street Northwest

Georgia Avenue Northwest

6th Street Northwest

Park Road Northwest

3608
E.L. Haynes
Public
Charter
School

Bruce Monroe
at Park
View Elementary
School

The Avenue
Yoga Heights

Spring-Laundromat

Giant Liquors

Bank of America

MPD Fourth
District
Substation

D & B Deli
Carryout

New York
Fried Chicken

Small Smiles
Dental Clinic

Capital
City Auto
Sales

Park Morton
Apartments

Georgia **A**venue **THRIVE**

To build an inclusive, connected, and vibrant community for the neighbors,
businesses, and visitors of lower Georgia Avenue.

Georgia Avenue Summer Festival Planning Meeting

Join us in creating the next great
community event. All are welcome to give input
to help Georgia Avenue Thrive!!!

Monday April 25, 2016

**Starting at 7PM @ Wall of Books
3325 Georgia Avenue NW**

for more information email us or call at
GeorgiaAvenueThrive@gmail.com or (202)854-9119

Search for us on FaceBook @ Georgia Avenue Thrive

Georgia **A**venue **THRIVE**

To build an inclusive, connected, and vibrant community for the neighbors,
businesses, and visitors of lower Georgia Avenue.

Georgia Avenue Summer Festival Planning Meeting

Join us in creating the next great
community event. All are welcome to give input
to help Georgia Avenue Thrive!!!

Monday April 25, 2016

**Starting at 7PM @ Wall of Books
3325 Georgia Avenue NW**

for more information email us or call at
GeorgiaAvenueThrive@gmail.com or (202)854-9119

Search for us on FaceBook @ Georgia Avenue Thrive

- Why not use Google Maps?
- What about government data?



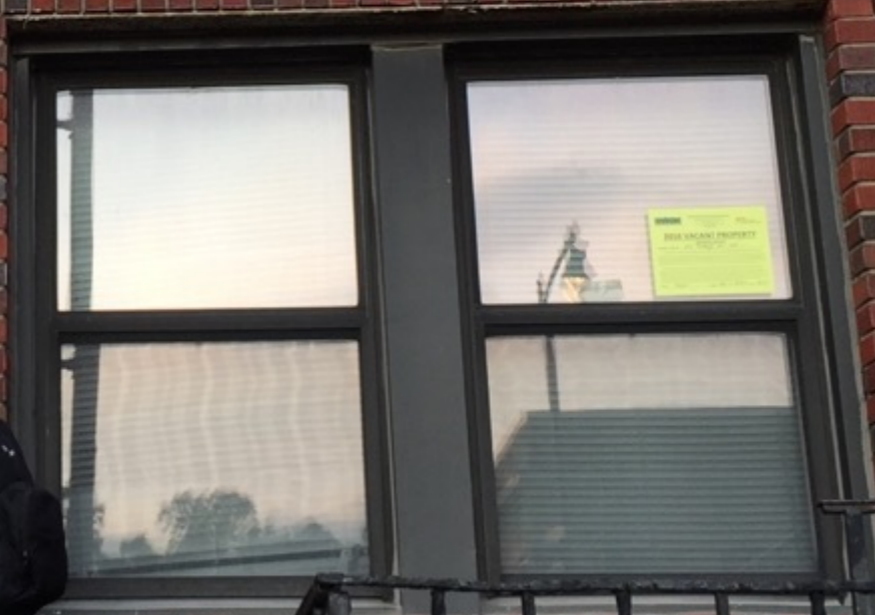

host
curt mariah
music by
dj xsa
dj wiilo
+
more

Join us as we launch

THE PERCH



3400 GEORGIA AVE NW
SUN JUNE 12TH 5-9PM

POSSIBILITY

PLAY SPACE

gather. connect. create



HOWARD UNIVERSITY
DEPARTMENT OF ATHLETICS
WWW.HOWARD.EDU
MEN'S
BASKETBALL
CROSS COUNTRY
FOOTBALL
SOCCER
SWIMMING & DIVING
TENNIS
TRACK & FIELD

HOWARD UNIVERSITY
DEPARTMENT OF ATHLETICS
WWW.HOWARD.EDU
WOMEN'S
BASKETBALL BOWLING
CROSS COUNTRY
TRACK & FIELD
SOFTBALL SOCCER
SWIMMING & DIVING
VOLLEYBALL
LACROSSE TENNIS

Welcome to the
District of Columbia
Small Business Development Center
At Howard University GADGET Center
We are in the Business of Helping
Small Business Succeed

HOWARD UNIVERSITY
ATHLETICS DEPARTMENT





Field Papers

INLINE +
GR-
MURAL

REST

<http://fieldpapers.org/atlas/1mr80reb/>

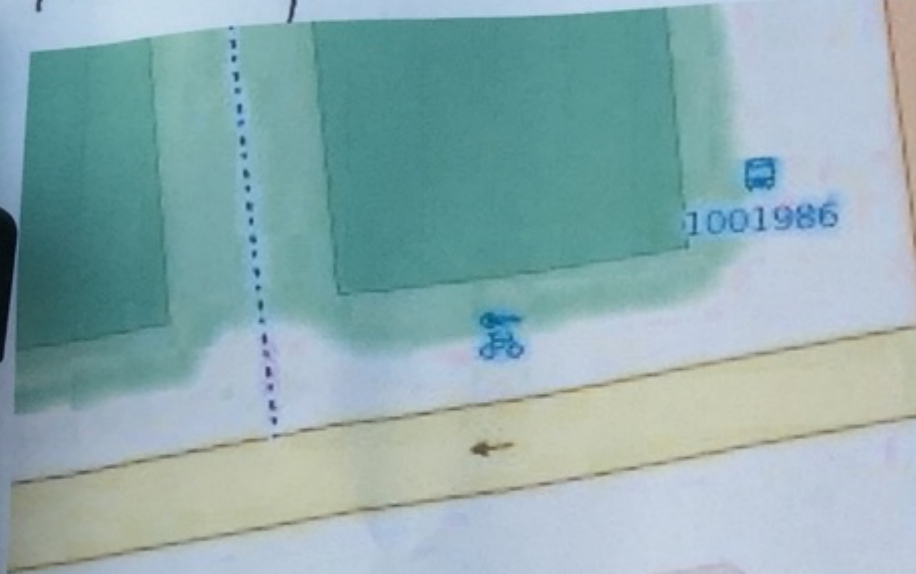

Columbia Road Northwest

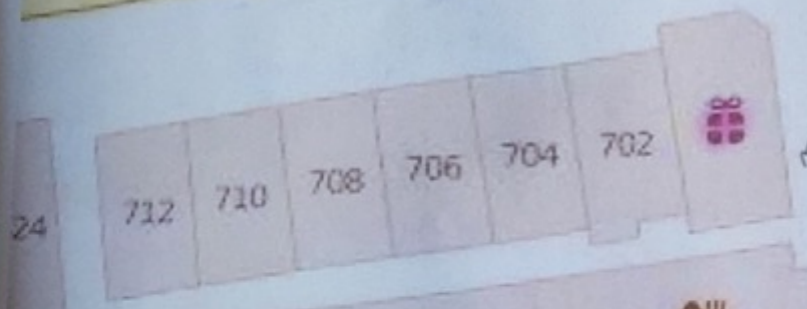

MURAL

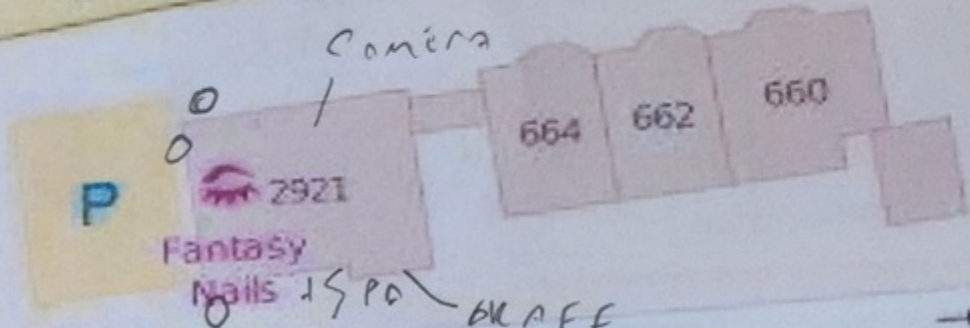

Camera

ISPA BLAFFE

THE LEMON BOWL
a place for makers

015 Georgia Avenue NW
Washington, D.C. 20001

www.thelemonbowldc.com
 ✉ hellolemonbowl@gmail.com
 📷 @thelemonbowldc

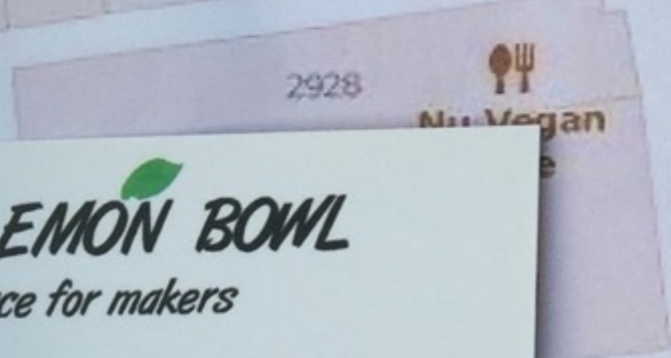

Georgia Avenue Northwest

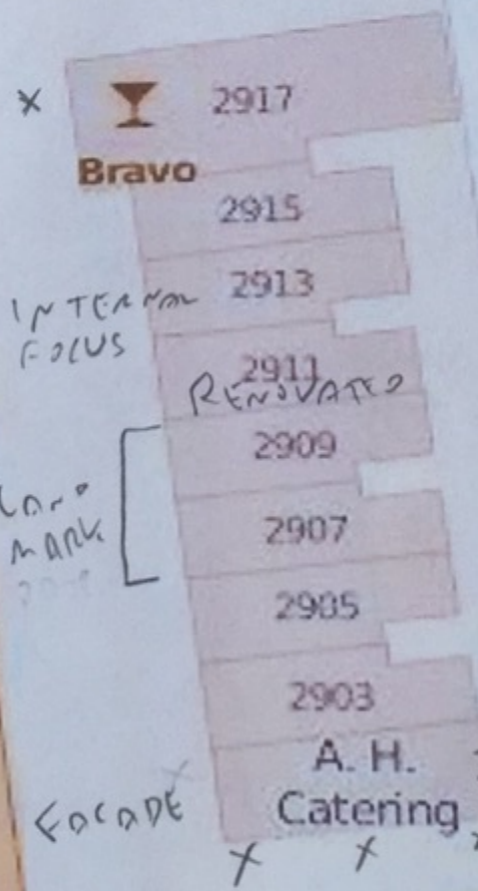

Bravo

INTERMEDIATE FOCUS

RENOVATED

CONDO MARK

EscAPE

A. H. Catering

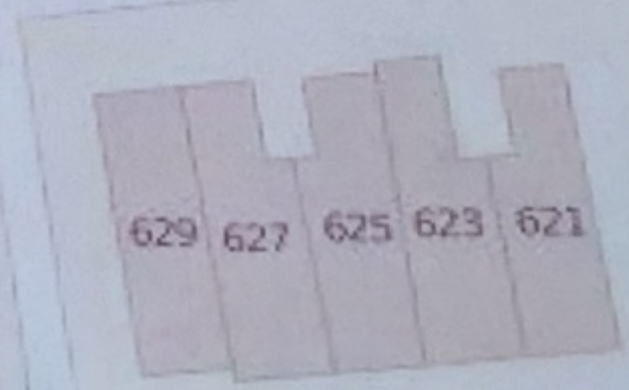
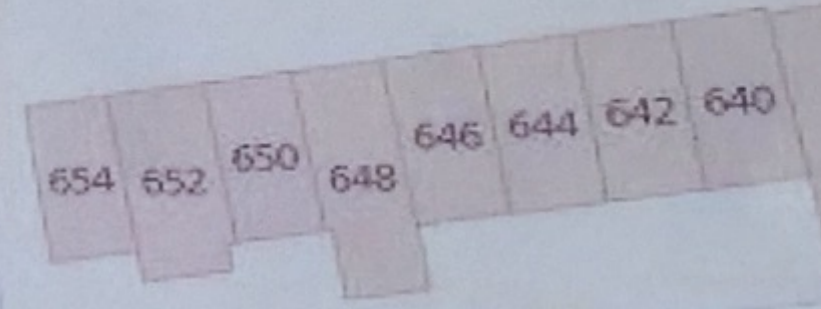

Harvard Street North

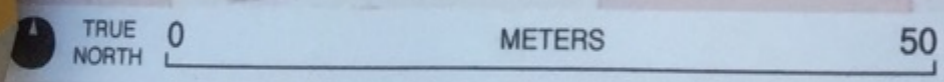

FOLIO



Why you should map with local groups

- They know about funding opportunities & project ideas
- They're going to stay invested for a while
- They know people!



BBC
BRIT
UNMISSABLE

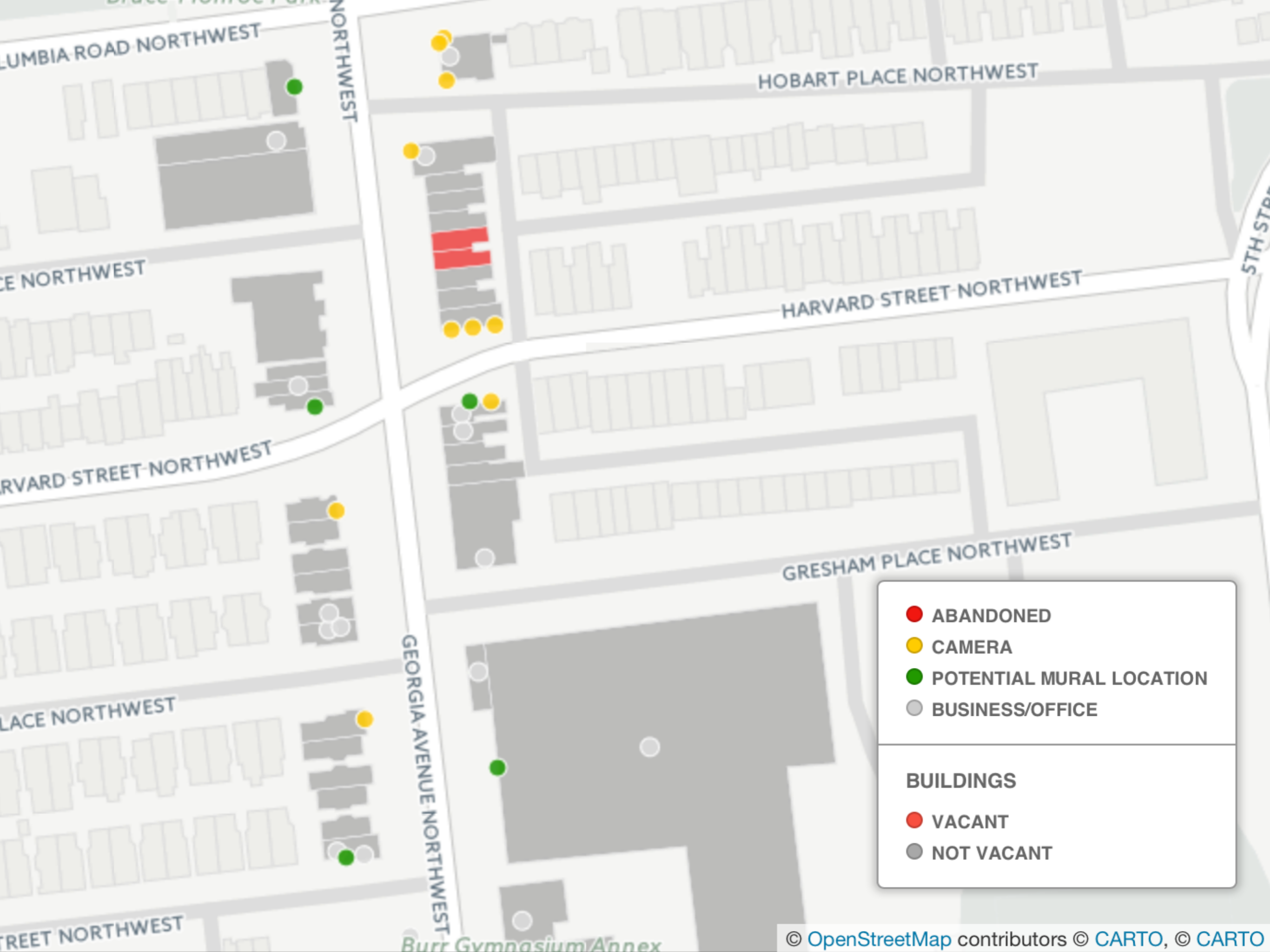

COLUMBIA ROAD NORTHWEST

NORTHWEST

HOBART PLACE NORTHWEST

CE NORTHWEST

HARVARD STREET NORTHWEST

RVARD STREET NORTHWEST

GRESHAM PLACE NORTHWEST

LACE NORTHWEST

GEORGIA AVENUE NORTHWEST

5TH ST NW

TREET NORTHWEST

Burr Gymnasium Annex

- ABANDONED
- CAMERA
- POTENTIAL MURAL LOCATION
- BUSINESS/OFFICE

BUILDINGS

- VACANT
- NOT VACANT

Next steps (for us)

- Tag building use type and do stats for types of businesses
- Distribute grant information for cameras, facades, murals
- Talk to vacant building owners
- Community review: present findings to the broader neighborhood & get more ideas!

Next steps (for us)

- Tag building use type and do stats for types of businesses
- Distribute grant information for cameras, facades, murals
- Talk to vacant building owners
- Community review: present findings to the broader neighborhood & get more ideas!

- Map change over time using Planet.osm files
- Neighborhood-map-data-extract-directory-maker-tool-thing?

Technical best practices

- CartoDB is great!! But a bit time consuming:
OSM->Overpass Turbo->QGIS->CartoDB
- **disused:building** tag isn't rendered, removing it from the map — bad if you are showing people not familiar with OSM

Non-technical best practices:

- Field map ahead of time so there's data to start with
- Easier if you are part of something: “we're with MappingDC” vs. “we're Steven and Andrew”
- Bring non-mappers with you when you do field mapping

Takeaways

- Field mapping is fun — but even more fun to use the data *for* something
- Work directly with existing local groups

Often we collect data and hope that someone will do something with it — but sometimes you have to be that someone

The more people you have doing mapping, the more representative the map will be

Be the change you want to be